

BATHTUB AND SHOWER INSTALLATION INSTRUCTIONS

IMPORTANT NOTES:

- **Review these instructions in their entirety prior to beginning your installation.** Ease of installation, proper fit and product performance depend on installing this product according to the instructions outlined here.
- **Multi-piece units with a wall surround must be fully assembled prior to positioning and securing it in the alcove,** as described in the upcoming steps. This assembly must occur inside the room of installation, as the finished unit will not fit through a standard interior door.
- **Watershed units are designed to hang from the mounting flanges** and do not require reinforcement under the bottom, such as mud, sand, concrete or mortar. The legs attached are for shipping purposes. They can be utilized to achieve level but are not required to bear weight/contact the floor in the final installation.
- **These instructions apply to any size Watershed bathtub or shower base.** If installing your unit without a coordinating Watershed wall surround, simply skip the unit assembly steps (steps 10-23) and secure the mounting flange of the tub/base in the same basic manner described for the surround (see page 8 for clarification and photo of finished unit).

WHAT YOU'LL NEED:

- Power drill/driver
- Tape measure
- Drain assembly
- Shims
- Drill & Screwdriver bits
- Pliers
- Silicone caulk
- Caulk gun
- Dry erase marker
- Hole saw
- Utility knife
- Level
- Safety glasses
- Work gloves

Recommended Hardware (not included):

- #8 screws, length required will vary based on installation location
- 1"x1/4" bolts with nuts & 2x washers

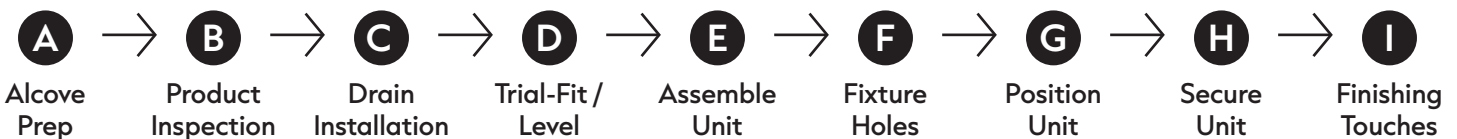



ALCOVE PREP

1. Ensure the alcove is the proper size, square, level, plumb and clean of dirt/debris.
2. Mounting to bare wall studs is preferred, but units can be installed over sheetrock/wallboard if the finished opening of the intended space coincides with your unit's measurements.
3. Rough-in drains should be located according to the line drawings for that particular unit.
4. If required, a one-hour fire wall can normally be obtained by placing 5/8" dry wall on the studs prior to the installation of the unit. Check local codes for requirements.



PRODUCT INSPECTION

5. Unbox product carefully and inspect.
6. Confirm product's measurements, color and drain location prior to beginning installation.



DRAIN INSTALLATION

7. Install the drain assembly of your choice according to the manufacturer's installation instructions. Be sure to use appropriate sealant between the flange and the finished side of the tub/shower to ensure a watertight seal.



A**B****C****D****E****F****G****H****I**Alcove
PrepProduct
InspectionDrain
InstallationTrial-Fit /
LevelAssemble
UnitFixture
HolesPosition
UnitSecure
UnitFinishing
Touches**TRIAL - FIT / LEVEL**

8. Place tub/shower base into the prepped alcove and check for level.
9. If adjustments are needed, gently overturn the unit and attach the necessary shims to the legs with screws.

8**9**

NOTE: Always use care to not drag the finished side of the fiberglass against the floor or any other surface, always lift and reposition.

FAQ: Why is my Watershed tub/shower base not level out of the box?

There are several reasons for this:

- Watershed units are designed to hang from the mounting flanges and do not require reinforcement under the bottom, such as mud, sand, concrete or mortar. The legs attached are mainly for shipping purposes. They can be utilized to achieve level but are not actually required to bear weight/contact the floor in the final installation.
- If adjustments are required, it is much better to add shims to the shipping legs than try to shave off any material.
- The front aprons on Watershed units are fully reinforced and assist the mounting flanges in weight distribution. They should always be installed tight to the floor and vertically plumb.



A

→

B

→

C

→

D

→

E

→

F

→

G

→

H

→

IAlcove
PrepProduct
InspectionDrain
InstallationTrial-Fit /
Level**Assemble
Unit**Fixture
HolesPosition
UnitSecure
UnitFinishing
Touches**ASSEMBLE UNIT –***Attaching the wall panels to each other*

10. Pre-drill the inside vertical flanges of the wall surround panels at the molded-in dimples.
11. Apply a ¼" bead of silicone caulk around the top of the tub/shower base flange where the bottom flange of the wall panels will nest.
12. Set one wall panel of the surround in place and apply a ¼" bead of silicone caulk along the vertical flange/panel seam.
13. Set the second panel in place.
14. From the back, locate the pre-drilled holes on the vertical flange and insert the bolt assemblies through the holes (one washer on each side of the seam).
15. Thoroughly tighten all bolt assemblies so the joint does not move.

Note: If the fiberglass material on the back is blocking a hole or hindering your ability to secure the washers and/or nuts, use a utility knife to gently scrape down the area.

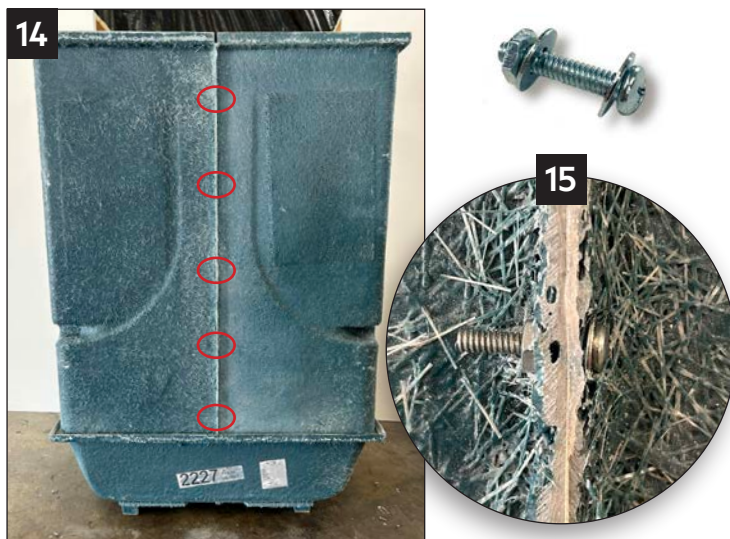
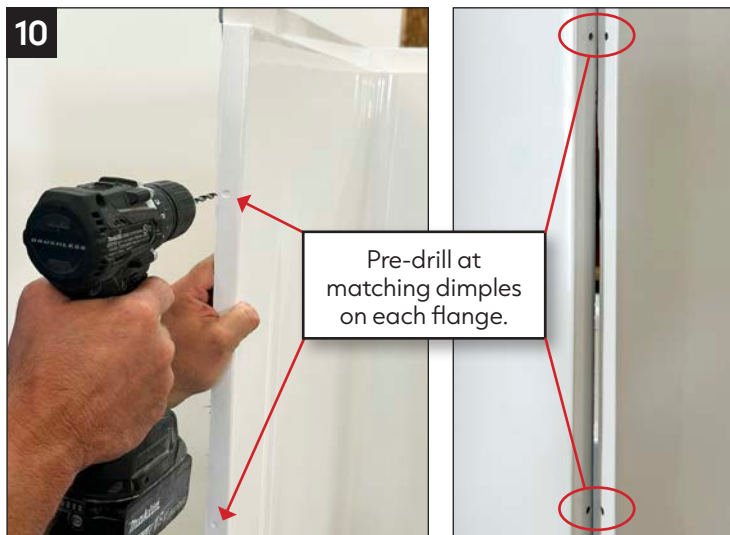

A

→

B

→

C

→

D

→

E

→

F

→

G

→

H

→

IAlcove
PrepProduct
InspectionDrain
InstallationTrial-Fit /
Level**Assemble
Unit**Fixture
HolesPosition
UnitSecure
UnitFinishing
Touches**ASSEMBLE UNIT –***Attaching the wall panels to the tub/shower base*

16. Ensuring that the wall panels are still in proper position, pre-drill and secure the front two corners of the wall panels to the tub/shower base with bolt assemblies.
17. Pre-drill and secure the two corners at the middle back vertical seam, applying pressure on the seam from the front to ensure that the panels are fully seated against the back of the flange and the front surfaces are properly aligned.
18. Pre-drill the remaining locations and secure with bolts, approximately every 12".
19. Wipe any excess caulk from the front surfaces that may have worked out of the seams during assembly. Caulk should not be visible from the front in the final installation.

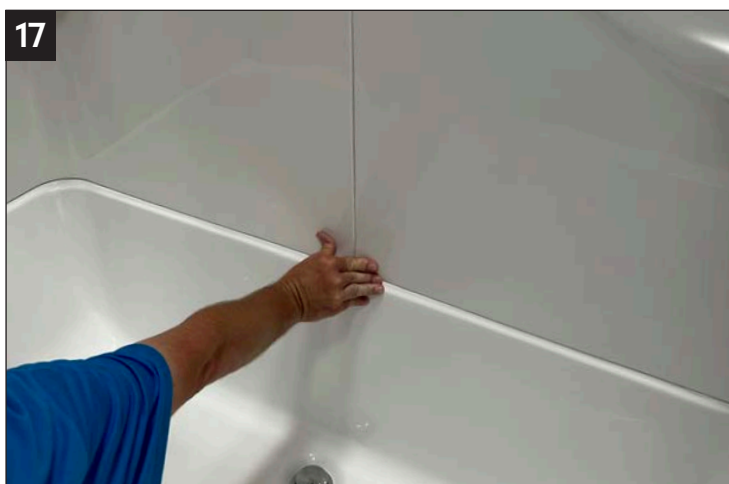
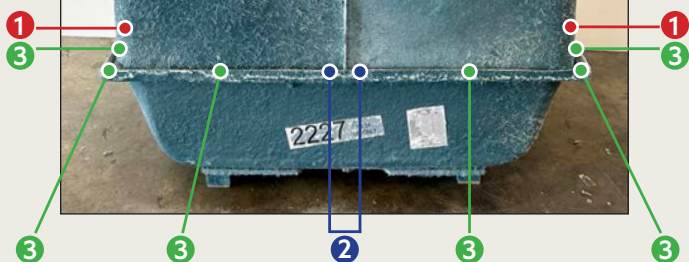
**16-18**

Drill & secure the horizontal flange bolts in the order outlined above, approximately every 12".

Note: Units larger than what is pictured here may require more bolts in between the corner anchors than the number shown here for illustration purposes.

A**B****C****D****E****F****G****H****I**Alcove
PrepProduct
InspectionDrain
InstallationTrial-Fit /
LevelAssemble
Unit**Fixture
Holes**Position
UnitSecure
UnitFinishing
Touches

CUT FIXTURE HOLES

20. Carefully measure the location(s) of the plumbing fixtures for which you need to cut holes.
21. Mark the center point(s) on the back of the unit in the proper location(s).

Note: Ensure you are measuring from edge of the mounting flange and not from the wall of the surround, as the flange is where the unit will contact the wall. A level held against the edge of the mounting flange can assist with this, see photo.

22. Drill a pilot hole (1/4" or less) from the back of the unit in the location(s) marked.
23. Using the pilot hole just drilled, cut out the fixture hole from the front with the appropriate-size hole saw for your fixture(s).

20**21****22****23**



POSITION UNIT IN ALCOVE

24. Move the assembled unit into the alcove by tipping the unit toward the installer and pushing the bottom until the waste pipe is directly under the drain outlet, then tip the unit upright into the alcove.
25. After the unit is positioned into the alcove, confirm level of shower or tub/shower. Make sure the apron is down tight to the floor and vertically plumb.



SECURE UNIT IN ALCOVE

26. The assembled unit **MUST** be mounted to wall studs. If installing over existing sheetrock/ wallboard, locate and mark the alcove's wall studs.
27. At the three panel intersection points, pre-drill holes through the center of the mounting flange and secure the unit using #8 screws.
28. Pre-drill the remaining locations. The front vertical flange holes should be approximately 12" apart.
29. Secure the front top corners.
30. Checking for gaps between the mounting flange and the remaining studs, secure all remaining locations with screws and insert shims where necessary.

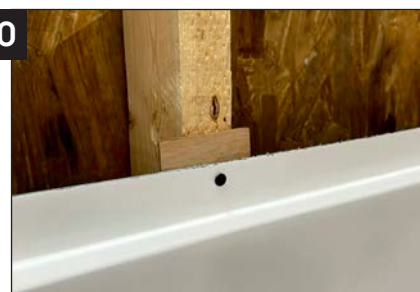
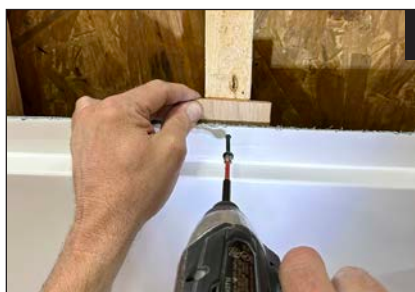

TUB - ONLY INSTALLATION

When installing a bathtub/shower base without a coordinating Watershed wall surround kit, simply skip the unit assembly outlined in steps 10-23 and jump to positioning the unit and securing the flange. Securing into wall studs is still required, but it is recommended to begin with the stud closest to the middle back and work your way forward and down.

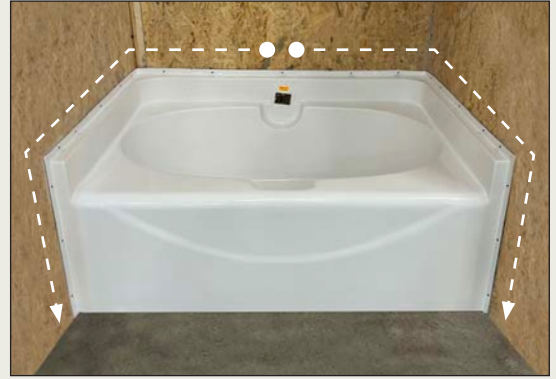

FINISHING TOUCHES

31. Install the drain connections and plumbing fixtures of your choice in keeping with good plumbing practices, in compliance with local code requirements and according to manufacturer instructions.
32. Complete the walls and edging on your unit (i.e. trim moulding, tile installation, wall panels, shower doors, etc.) according to requirements, homeowner preferences and manufacturer instructions.



CARE AND CLEANING INSTRUCTIONS

After installation, the unit may be cleaned with liquid detergent and warm water.

Never use a harsh chemical or abrasive cleaners, as they may dull or yellow the surface. Never use any cleaning products that are labeled not to use with styrene type products.

In the event that the surface is dulled, the finish may be restored by using an automotive white polishing compound applied with cheese cloth or other soft cloth. Rub vigorously and then wipe off all residue. A good automotive wax can be used to complete the refinish and restore shine.